

REV	LOCATIONS	DESCRIPTION	DATE	REVISER	APPD
1	△	Add dimension "C"	25/MAR/20	KATE	FRANK
2	△	Size Changes	20/APR/22	MATT	KATE
3	△	Size Changes	27/JUL/23	MATT	LEO
4	△	Add numbers 44	27/AUG/24	FAY	LEO

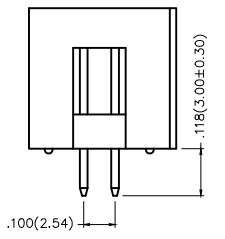
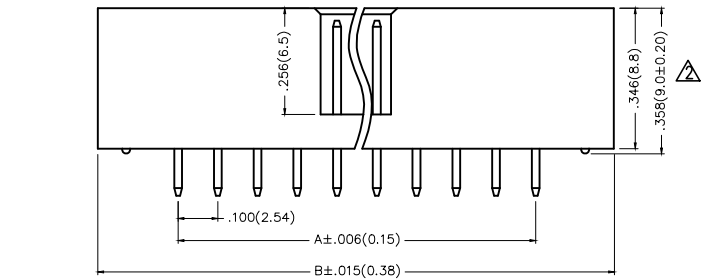
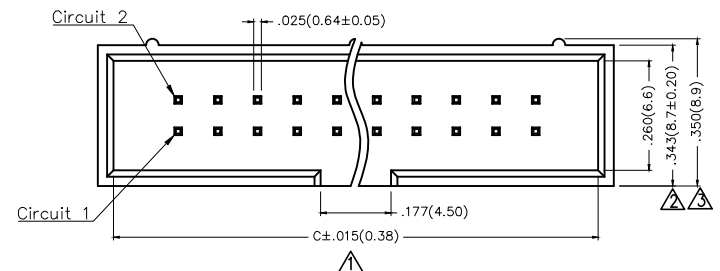

Electrical
 Current Rating: 3.0A AC(rms)/DC
 Voltage Rating: 250V AC(rms)/DC
 Contact Resistance: 20 mΩ Max
 Insulation Resistance: 1000 MΩ MIN
 Withstanding Voltage: 500V AC r.m.s
 Temperature Range—Operating: -40°C~+105°C

Material and Plating
 Housing: Polyester (UL94V-0)
 Contact Pin: Brass
 Plating: Gold Plated/Selective gold in contact area, tin on tail

Ordering Information

FBH 254 01 - D XX S X XX X XX K
 1 2 3 4 5 6 7 8 9 10 11

1	Category FBH—Box Header	2	Series Number 254—Pitch 2.54mm	3	Distinction No. 01	4	Row Option D—Double Row	5	Circuits XX	6	Entry Angle S—180° Vertical
7	Plating 1—Gold Plated 3—Selective gold in contact area, tin on tail	8	Thickness of Plating 00—Gold Flash 05—5μ" Custom plate available	9	Material—Resin 1—PBT 3—LCP 4—PA9T	10	Color—Resin K6—Black W1—White	11	Packaging K—Tray		

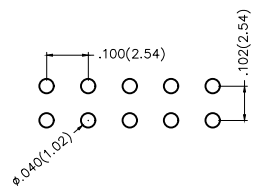

Recommended P.C.Board Layout

Circuits (n)	Part No.	Dimensions(in/mm)			Circuits (n)	Part No.	Dimensions(in/mm)		
		A	B	C			A	B	C
6	FBH25401-D06SXXXXXX	.200(5.08)	.601(15.27)	.520(13.22)	28	FBH25401-D28SXXXXXX	1.300(33.02)	1.701(43.21)	1.620(41.16)
8	FBH25401-D08SXXXXXX	.300(7.62)	.701(17.81)	.620(15.76)	30	FBH25401-D30SXXXXXX	1.400(35.56)	1.801(45.75)	1.720(43.70)
10	FBH25401-D10SXXXXXX	.400(10.16)	.801(20.35)	.720(18.30)	32	FBH25401-D32SXXXXXX	1.500(38.10)	1.901(48.29)	1.820(46.24)
12	FBH25401-D12SXXXXXX	.500(12.70)	.901(22.89)	.820(20.84)	34	FBH25401-D34SXXXXXX	1.600(40.64)	2.001(50.83)	1.920(48.78)
14	FBH25401-D14SXXXXXX	.600(15.24)	1.101(25.43)	.920(23.38)	36	FBH25401-D36SXXXXXX	1.700(43.18)	2.101(53.37)	2.020(51.32)
16	FBH25401-D16SXXXXXX	.700(17.78)	1.201(27.97)	1.020(25.92)	40	FBH25401-D40SXXXXXX	1.900(48.26)	2.301(58.45)	2.220(56.40)
18	FBH25401-D18SXXXXXX	.800(20.32)	1.201(30.51)	1.120(28.46)	44	FBH25401-D44SXXXXXX	2.100(53.34)	2.501(63.53)	2.420(61.48)
20	FBH25401-D20SXXXXXX	.900(22.86)	1.301(33.05)	1.220(31.00)	50	FBH25401-D50SXXXXXX	2.400(60.96)	2.801(71.15)	2.720(69.10)
24	FBH25401-D24SXXXXXX	1.100(27.94)	1.501(38.13)	1.420(36.08)	60	FBH25401-D60SXXXXXX	2.900(73.66)	3.301(83.85)	3.220(81.80)
26	FBH25401-D26SXXXXXX	1.200(30.48)	1.601(40.67)	1.520(38.62)	64	FBH25401-D64SXXXXXX	3.100(78.74)	3.501(88.93)	3.420(86.88)

 THIRD ANGLE PROJECTION	GENERAL TOLERANCES (UNLESS SPECIFIED)		APPROVE BY FRANK	DATE 19/JUL/13	PART NO. FBH25401-DXXSXXXXXX	ITEM NO. FBH25401	 Leader Of Industry
	X.±.012(0.30)	X.±5'	CHECKED BY CHERRY	DATE 19/JUL/13	TITLE Wire to Board(Box Header) Pitch 2.54mm Vertical 180°(DIP)		
	X.X±.010(0.25)	X.±2'	DRAWN BY JACOB	DATE 19/JUL/13	REV 4	SHEET NO. 1/1	
	X.XX±.008(0.20)	.XX±1"	THIS DRAWING CONTAINS INFORMATION THAT IS PROPRIETARY TO TXGA INDUSTRIAL ELECTRONICS(S.Z)CO.,LTD AND SHOULD NOT BE USED WITHOUT WRITTEN PERMISSION				
SCALE 5:1	SIZE A4	X.XXX±.004(0.10)	.XXX±0.5'				